

OK



CITY OF NAPOLEON  
BUILDING & ZONING DEPARTMENT  
255 W. Riverview Avenue, PO Box 151, Napoleon, OH 43545  
Phone: 419-592-4010 - Fax: 419-599-8393

SCANNED  
+ Final

### APPLICATION FOR SIGN PERMIT

LOCATION OF PROPERTY: 1223 N. SCOTT ST.

OWNER NAME: JKL PROPERTIES, LLC PHONE: 419-599-5540

OWNER ADDRESS: 1223 N. SCOTT ST., NAPOLEON, OH 43545

CONTRACTOR NAME: HARMON SIGN PHONE: 419-841-6656

IS CONTRACTOR REGISTERED WITH THE CITY OF NAPOLEON?  YES  NO

#### SIGN INFORMATION

TYPE:  POST  WALL  GROUND  AWNING

DIMENSIONS: 93" h x 101" w = TOTAL S.F. 65.23

\*\* PLEASE INCLUDE ANY AND ALL SITE PLANS AND PLANS OF ABOVE SIGNS.

#### FEES:

\$35.00 BASE UP TO 50 S.F. OF SIGN, PLUS \$0.20 PER ADDITIONAL S.F., NOT TO EXCEED \$150.00 = \$38.05

\$5.00 FLAT FEE FOR TEMPORARY SIGNS, TEMPORARY SPECIAL EVENT SIGNS, AND PORTABLE SIGNS OTHER THAN THOSE EXEMPT FROM FEE.(SEE BELOW)

NO FEE REQUIRED FOR TEMPORARY AND EASILY REMOVABLE 1<sup>ST</sup> AMENDMENT SIGNS, OR SIGNS RELATED TO RELIGIOUS OR CHARTIABLE CAUSES OR EVENTS.

APPLICANTS SIGNATURE

2/5/08

DATE



**MONUMENT SIGN**



This design & engineering is submitted as our proposal & is to remain our property exclusively until accepted & approved by purchase © COPYRIGHT 2005



SALESMAN	DAVE BRINK	DRAWING#	005681-1	REVISION DATE	KJP 8-13-07	DRAWN BY/DATE	KJP 4-13-07
JOB NAME/LOCATION	BYK INSURANCE / NAPOLEON, OH	SCALE	NO SCALE	FILENAME	BYKIN-NO-07-MON-1 PIC 08-13-07		

## MONUMENT SIGN

**DOUBLE FACE ILLUMINATED MONUMENT SIGN. TRIANGLE CABINET TO BE MAP CUSTOM COPPER #2 WITH ROUTED BLACK FACE, PUSH-THRU COPY, FROSTED GOLD CRYSTAL FACES, AND WHITE HALO ILLUMINATION. "BOKERMAN, YA..." CABINET TO BE MAP CUSTOM COPPER #2 WITH ROUTED FACE, PUSH-THRU COPY, BLACK FACES, AND WHITE HALO ILLUMINATION. "INSURANCE" TO BE ROUTED WITH TRANSLUCENT FROSTED GOLD CRYSTAL VINYL. POLE SHROUD TO BE MAP CUSTOM COPPER #2 WITH 6" BLACK ADDRESS NUMBERS. FOUR LINED, COLOR 19MM ELECTRONIC MESSAGE CENTER.**

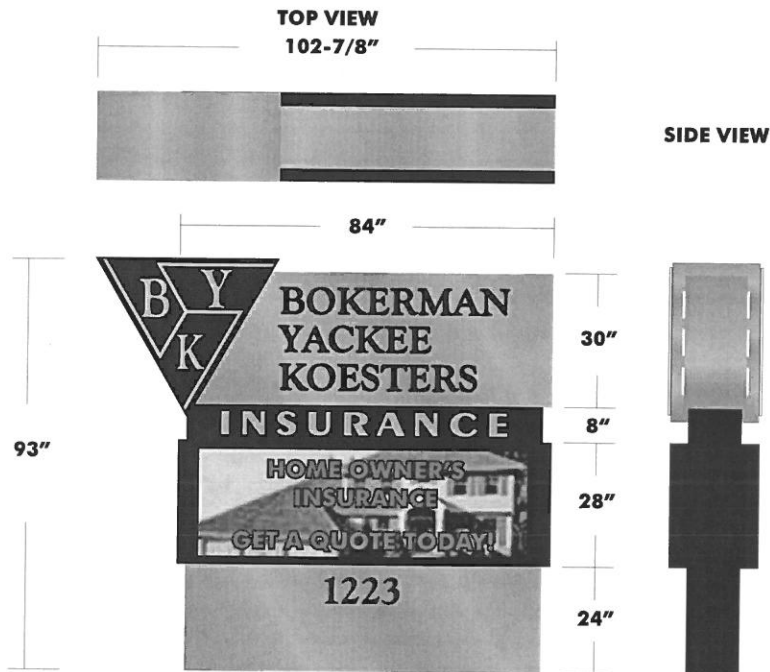

This design & engineering is submitted as our proposal & is to remain our property exclusively until accepted & approved by purchase. © COPYRIGHT 2005

SALESMAN DAVE BRINK DRAWING# 005681-1 REVISION DATE KJP 8-13-07 DRAWN BY/DATE KJP 4-13-07  
 JOB NAME/LOCATION BYK INSURANCE / NAPOLEON, OH SCALE 3/8"=1'-0" FILENAME BYKIN-NO-07-MON-1 08-13-07

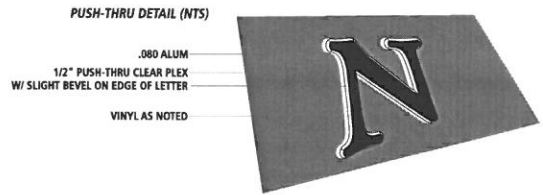
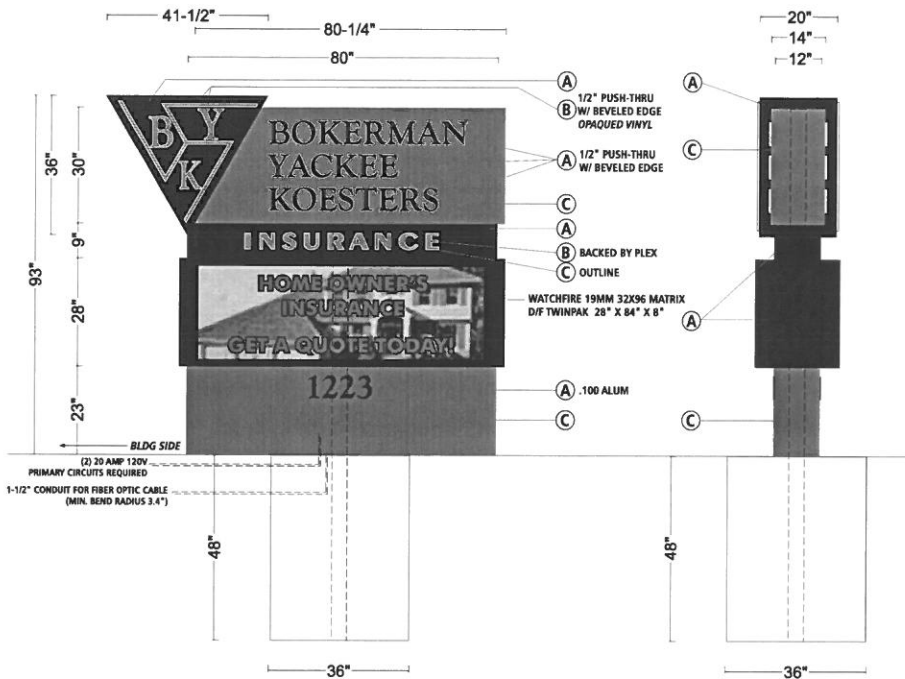

**LOGO CABINET**

QTY. 1  9\"/>

**LOGO FACE**

QTY. 2  NEW  REPLACEMENT - TRIM .38\"/>

**MAIN ID CABINET**

QTY. 1  9\"/>

**MAIN ID FACE**

QTY. 2  NEW  REPLACEMENT - TRIM .38\"/>

**'INSURANCE' CABINET**

QTY. 1  9\"/>

**'INSURANCE' FACE**

QTY. 2  NEW  REPLACEMENT - TRIM .38\"/>

037087-3-1

	JOB# _____ DRAWING# _____ JOB NAME/LOCATION BOKERMAN, YACKEE, KOESTERS / NAPOLEON, OH SALES/REP D.BRINK QUOTE# _____ APPROVED BY/DATE _____ <small>This design &amp; engineering is submitted as our proposal &amp; is to remain our property exclusively until accepted &amp; approved by purchase order.</small>	REVISION DATE 08-11-25-08 1/2" = 1'-0" BYKIN-NO-07-MON-P	DRAWN BY/DATE K.PRANGER 8-13-07 SCALE 1/2" = 1'-0" BYKIN-NO-07-MON-P
--	---	---	--

- A. BLACK
- B. 180C-229 COPPER METALLIC VINYL
- C. MAP CUSTOM COPPER (MP23469/MP23560) PER SAMPLE OPTION #2
- D. 7725SE-331 FROSTED GOLD CRYSTAL VINYL

← N. SCOTT ST →

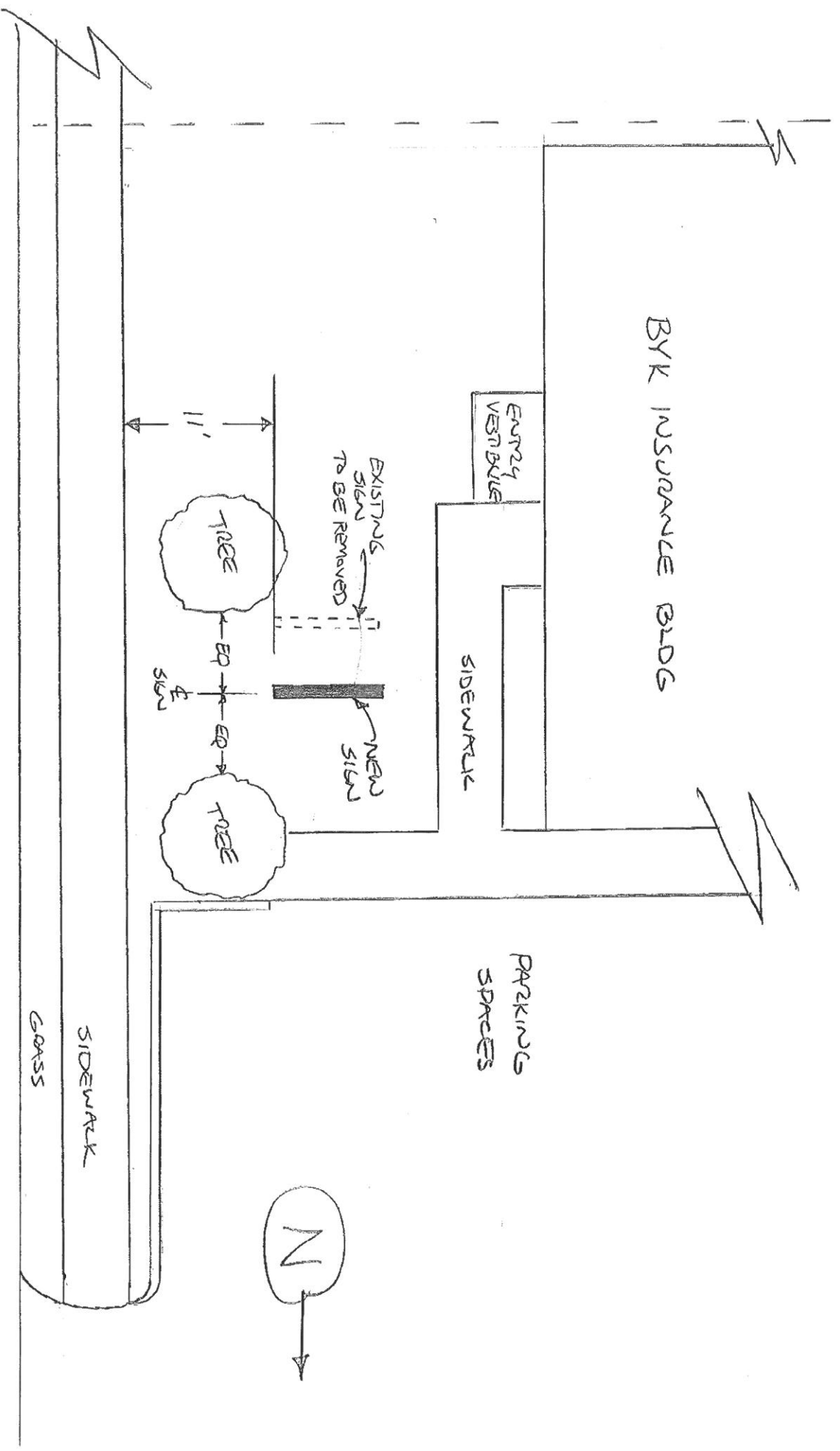

BYK INSURANCE BLDG

ENTRY VESTIBULE

SIDEWALK

PARKING SPACES

TREE

TREE

EXISTING SIGN TO BE REMOVED

NEW SIGN

11'

EQ

EQ

GRASS

SIDEWALK

N

# Henry County GIS

**PUBLIC ACCESS SYSTEM**

Date: February, 5 2008

This map was prepared as the tax map for Henry County as prepared by the Henry County Engineer in accordance with Section 5713.09 of the Ohio Revised Code. Henry County assumes no legal responsibility for the information contained on this map. Users noting errors or omissions are encouraged to contact the Henry County Tax Map Department.



Map #: 05-14-226-022  
 Parcel #: 410093670200  
 Owner: BOKERMAN, JOEL, TRUSTEE  
 Address: P O BOX 563  
 NAPOLEON OH 43545

Acres: 0.00000  
 Tax District: 41  
 Location: 1223 N SCOTT ST  
 Parc Suf: 01  
 Deed: V 203P1017

Legal Line 1: LOT 13 MEHRING 1ST ADD  
 Legal Line 2: E 80' & VAC ST  
 Legal Line 3:  
 Frontage: 000000  
 Depth: 0080

Building Taxes: 18990  
 Land Taxes: 3050  
 Total Taxes: 27040  
 Cav Value: 0

